

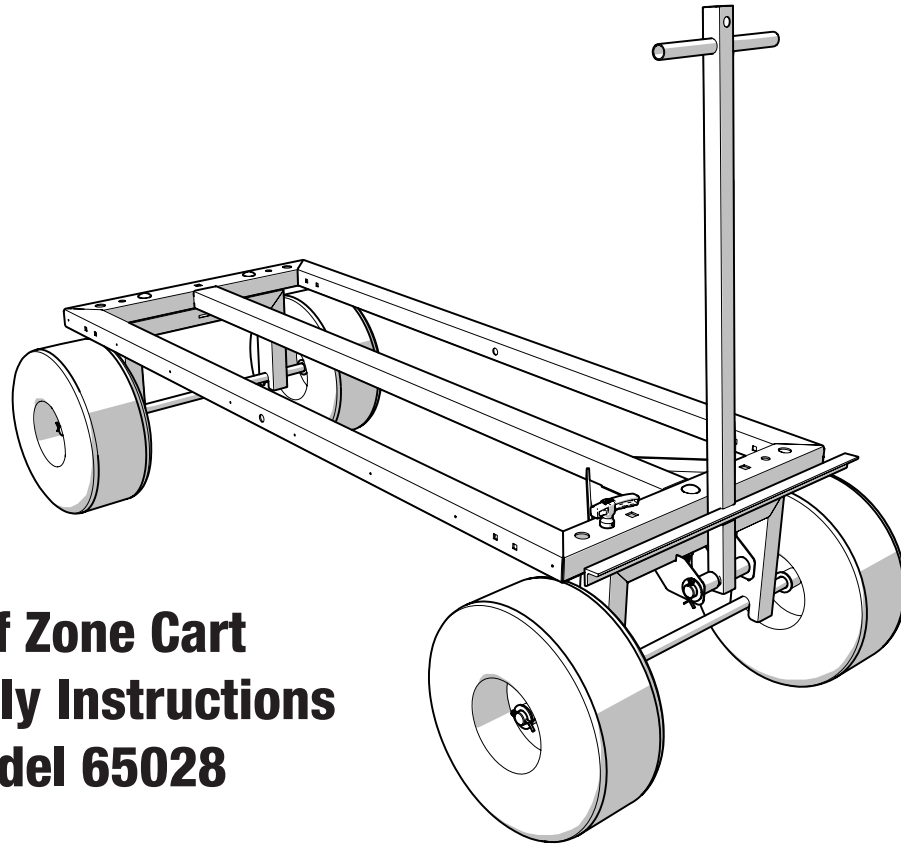

PENETRATOR

MOBILE FALL PROTECTION



Roof Zone Cart Assembly Instructions Model 65028

Important – Please Read These Instructions Fully Before Starting Assembly

If you need have damaged or missing parts, call the Customer Service: 404-344-0000

- Check you have all the components listed on pages 2.
- Remove all parts from the plastic bags and separate them into their groups.
- Keep children and animals away from the work area, small parts could choke if swallowed.
- Make sure you have enough space to layout the parts before starting.
- Assemble on a hard level surface.
- Assembly of the axles/frame will be easier with 2 people.

Instruction Sheet #08262 Rev. 3-3-16

TIE DOWN ENGINEERING • 255 Villanova Drive SW • Atlanta, GA 30336
www.tiedown.com (404) 344-0000 Fax (404) 349-0401



E1447

Components - Complete Parts List

Please check you have all the component parts listed below

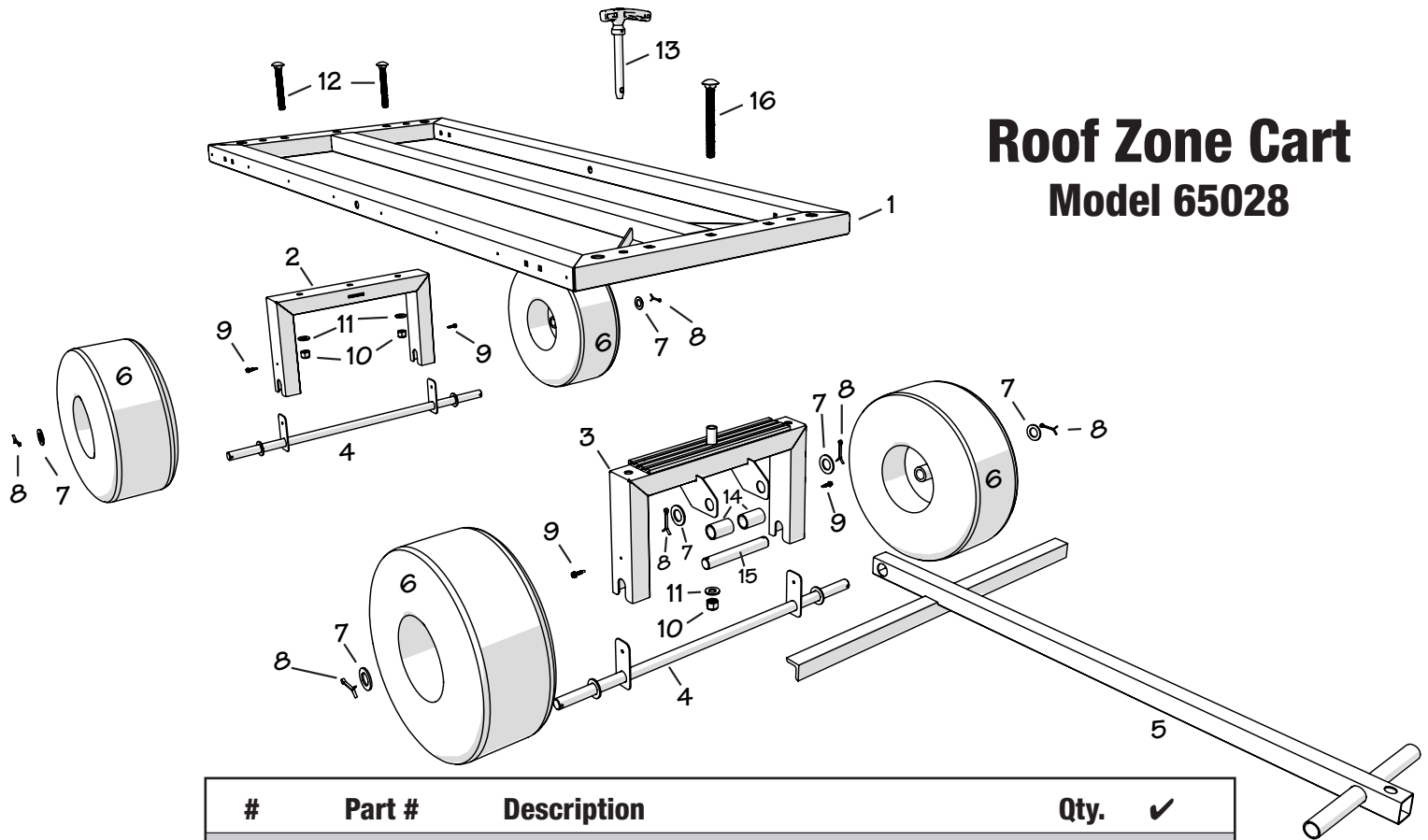

Roof Zone Cart Model 65028

#	Part #	Description	Qty.	✓
1	65027-1	Penetrator Cart Frame	1	
2	65027-6	Rear Axle Frame	1	
3	65027-2A	Front Axle Frame	1	
4	65027-5	Axle Assembly	2	
5	65027-3	Handle/Brake Assembly	1	
6	13844	Flat Free Tire - 18"	4	
7	10250Z	Flat Washer - 1" zinc	6	
8	10691	Cotter Key - 3/16" x 2"	6	
9	10846	Tek Screw #14 x 1" zinc	4	
10	10628	Nylock Nut - 5/8 - 11 zinc Grade 2	3	
11	10153Z	Flat Washer - 5/8" Zinc	3	
12	10455	Carriage Bolt - 5/8x11 x 5"	2	
13	70509	Pull Pin - 5/8" x 3"	1	
14	65027-3-3	Bushing - Cart Handle	2	
15	65018-4-2Z	Handle Pin - 1"	1	
16	10456	Carriage Bolt - 5/8-11 x 6"	1	

If you need have damaged or missing parts, call the Customer Service: 404-344-0000

Assembly Instructions

Rear Axle Frame (#2)

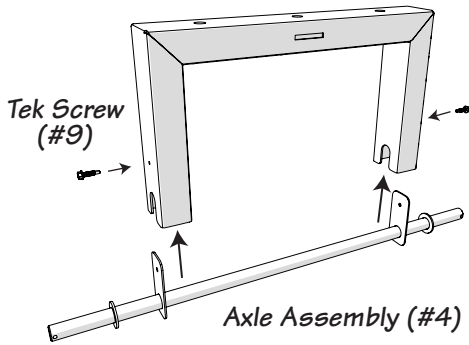

Step 1

Slide the axle assemblies onto the front/rear axle frames, the axle brackets will be on the outside of the axle frames.

Attach the axle to the frame with one tek screw (#9) on each side of the axle frames.

Front Axle Frame (#3)

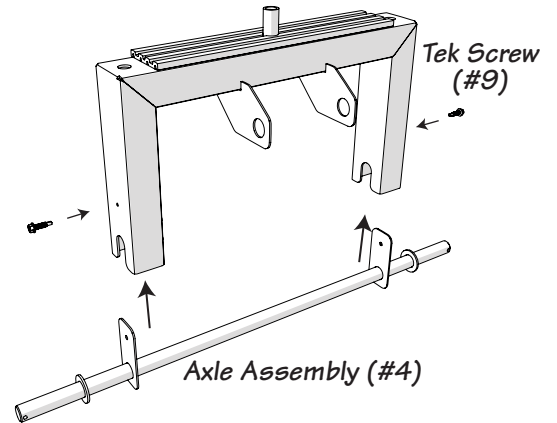

Step 2

Lay the cart frame flat on hard ground. Position axle frames front and back of the cart. The axle frames will stand on their own.

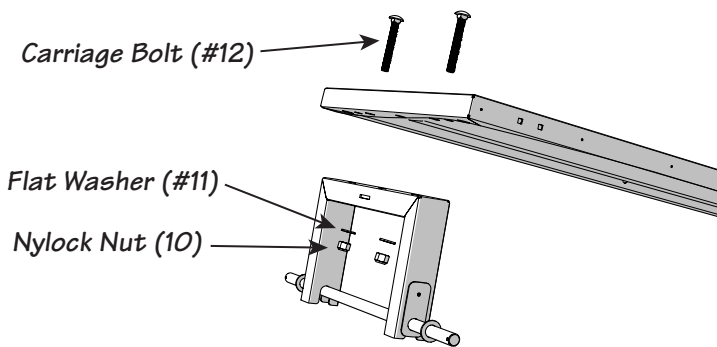
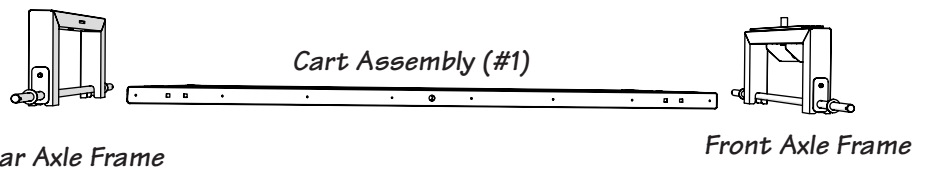

Step 3

Lift the rear cart frame (may require two people). Align the mounting holes with the axle and cart frame.

Insert carriage bolts thru cart frame and axle frame, attach with washers and nylock nuts. Tighten nuts/bolts.

Step 4

Lift the front cart frame (may require two people). Align the center mounting hole with the axle and cart frame.

Insert carriage bolt thru cart frame and axle frame, attach with washer and nylock nut. Tighten the nut/bolt just enough for the axle frame to turn freely (Do not over tighten).

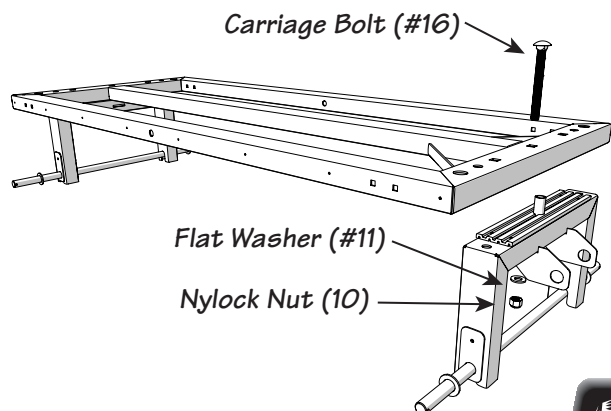

Assembly Instructions

Step 5

Lift the front or the rear cart (may require two people).
Slide the flat free tires onto the axle.

Install a washer over the axle shaft, insert cotter key through the axle mounting hole. Split the cotter key securing the tire to the axle frame. Repeat for all four tires.

Flat Washer (#7)

Cotter Key (#8)

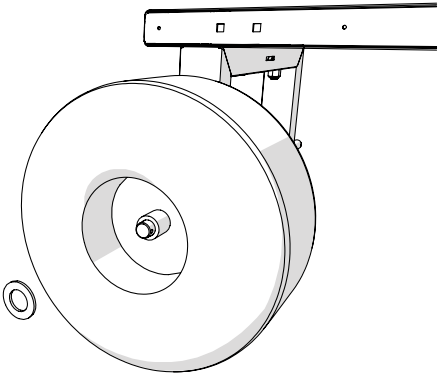

Step 6

Install and split open cotter key on ONE end of the handle pin (#15), slide on ONE washer. Insert the handle pin through the handle guide bracket on the front axle. Slide one bushing over the handle pin.

Position/align the handle assembly with the handle pin/bushing. Slide the handle pin with bushing through the handle assembly tube while aligning the second bushing with the handle pin.

Once the handle pin is aligned with the second bushing, slide the entire assembly through the opposite handle guide bracket. Slide on a flat wash, install and split open the cotter key.

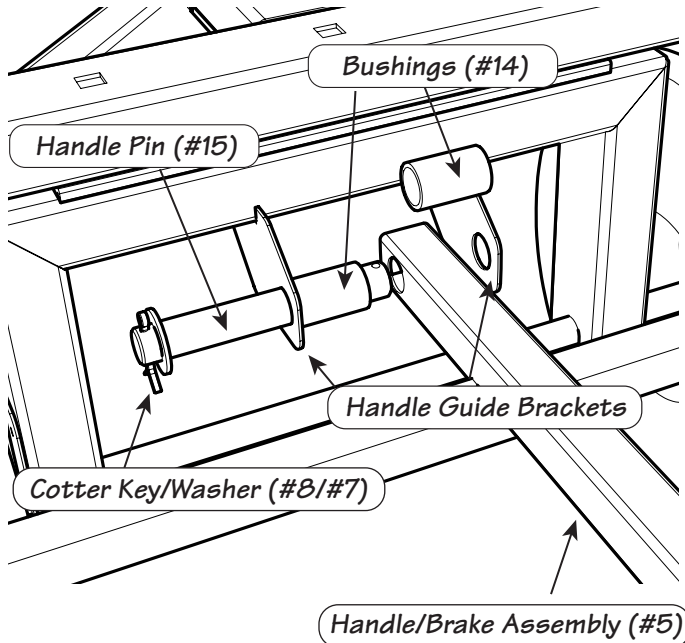

Step 7

The Penetrator Roofing Cart has the option of locking the steering with a pull pin (both sides).

To lock the front steering: place the pull pin into the smaller inside round hole.

Steering Lock Position Holes

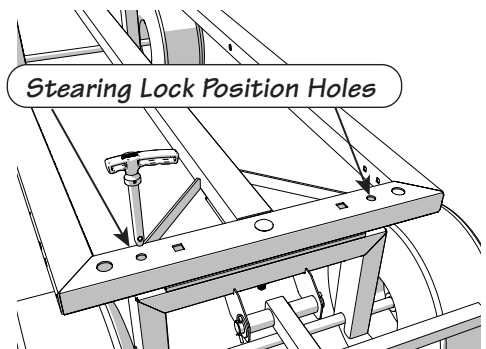

Roof Zone is a Division of
TIE DOWN ENGINEERING
255 Villanova Drive SW • Atlanta, Georgia 30336
800-241-1806 • 404-344-0000 • Fax 404-349-0401
ISO 9001:2008 Certification
Trade, brand names and drawings are the intellectual property of
TIE DOWN ENGINEERING. ©2016 TIE DOWN, Inc.
Instruction #08262 (E1447 Rev. 3-3-2016)

